

# KJC TYPE

## 주요용도 (Application)

공작기계, 용접로봇, 자동차산업, 목공기계, 반도체 생산설비 자동화 설비 등에 적용

## 특징 (Features)

밀폐형으로 이물질로부터 Cable, Hose 를 보호할수 있으며, Cover가 개폐되어 Cable, Hose 의 설치가 쉬우며 본체가 Pin으로 연결하는 구조로 되어 있어 기장의 늘임과 줄임이 쉽습니다.

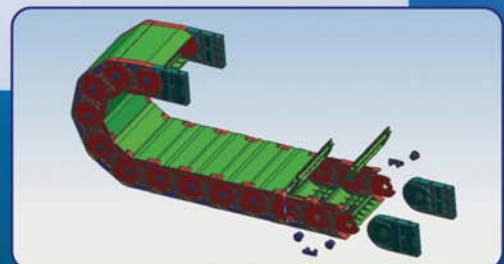

# KJC 045 TYPE

● **Cablechain / Chain Pitch(P)=45mm**

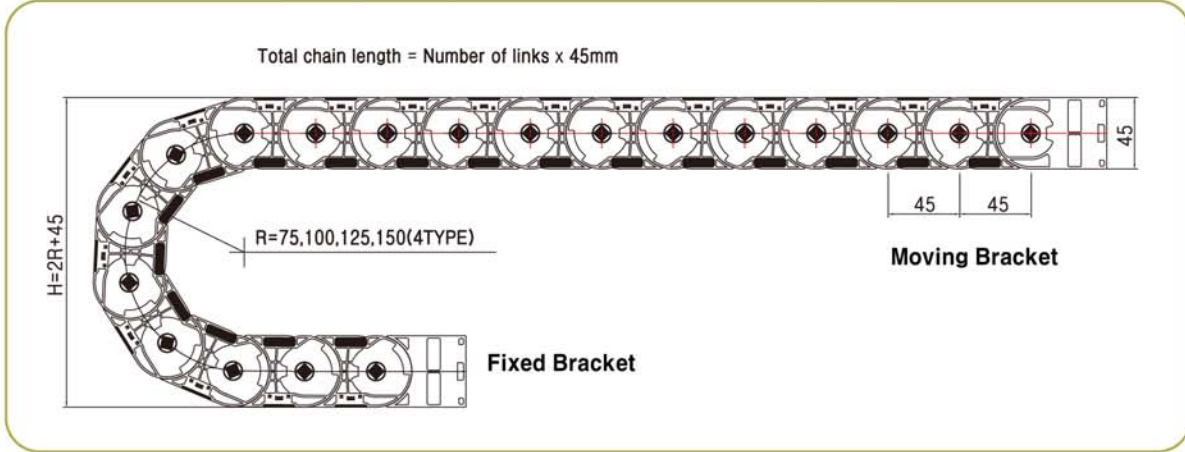

● **A-A Cross Section / D. Max**

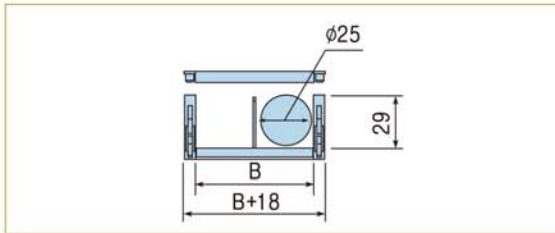

- Chain Length  $L = \frac{Ls}{2} + \pi R + 3P(2K)$
- 곡률반경에 따른 H값

R	75	100	125	150
H	195	245	295	345

● **B 50**

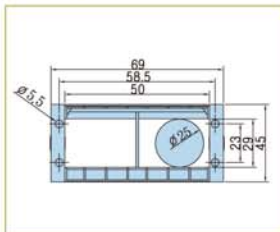

● **B 75**

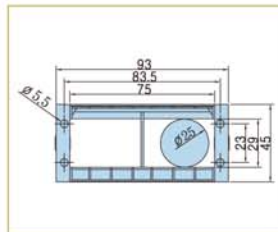

● **B 100**

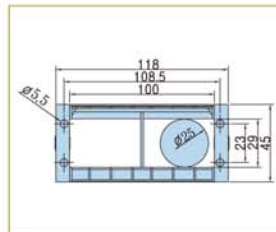

● **B 125**

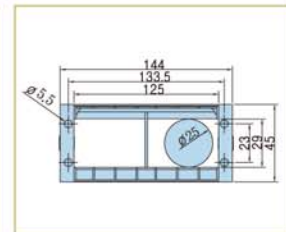

● **End Bracket**

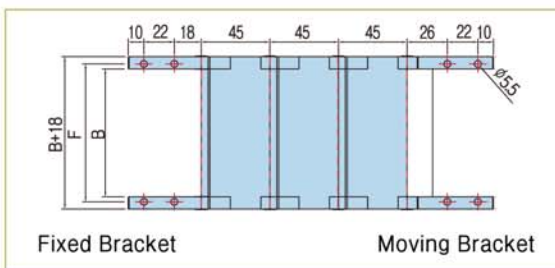

단위 mm

SERIES WITH RODS	F(B+8.5)
KJC 045-B50	58.5
KJC 045-B75	83.5
KJC 045-B100	108.5
KJC 045-B125	133.5

● **Order Example [주문예]**

KJC 045-B50 / Type → R75 / Radius → 50L/K / Length → 3Sets / Q'ty

● **Cablechain /** Chain Pitch(P)=65mm

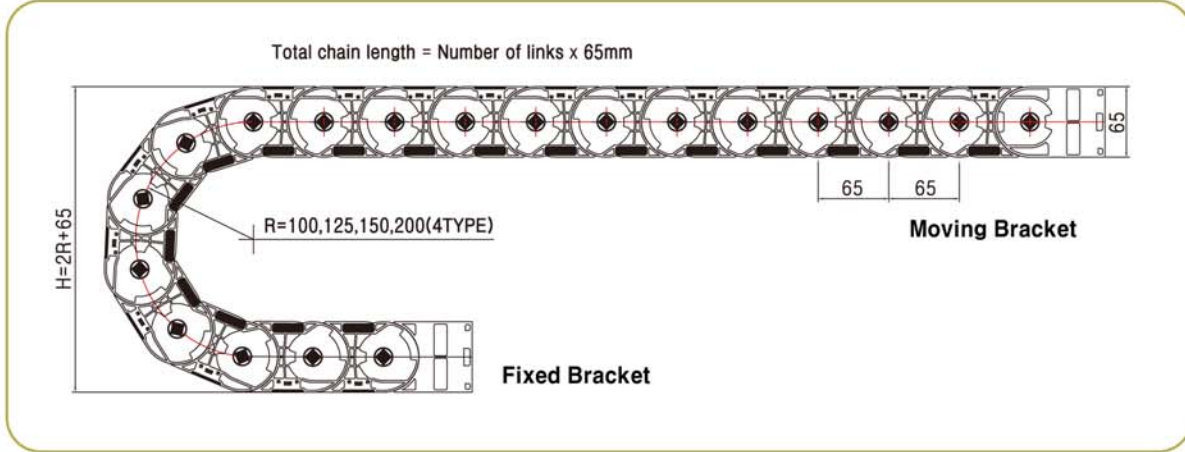

● **A-A Cross Section / D. Max**

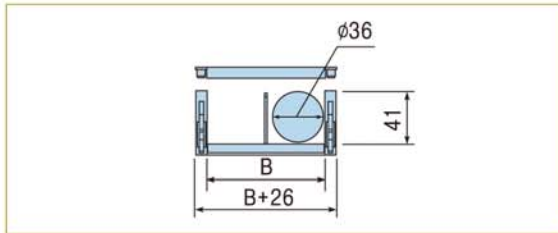

- Chain Length  $L = \frac{Ls}{2} + \pi R + 3P(2K)$
- 곡률반경에 따른 H값

R	100	125	150	175	200
H	266	316	366	416	466

● **B 75**

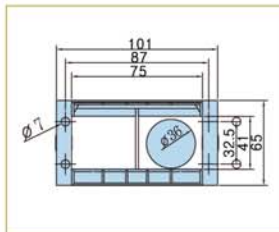

● **B 100**

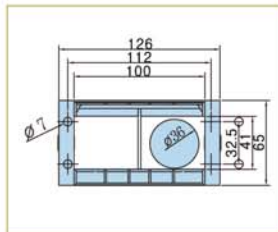

● **B 125**

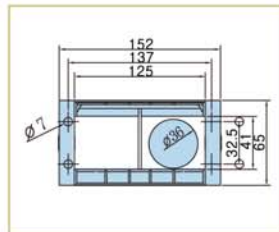

● **B 150**

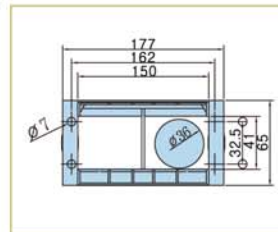

● **End Bracket**

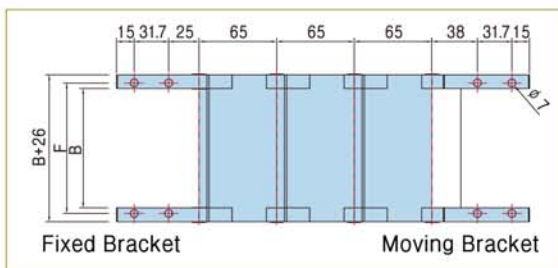

단위 mm	
SERIES WITH RODS	F(B+12)
KJC 065-B75	87
KJC 065-B100	112
KJC 065-B125	137
KJC 065-B150	162

● **Order Example** [주문예]

KJC 065-B100 / Type → R150 / Radius → 50L/K / Length → 5Sets / Q'ty

# KJC 090 TYPE

● **Cablechain** / Chain Pitch(P)=90mm

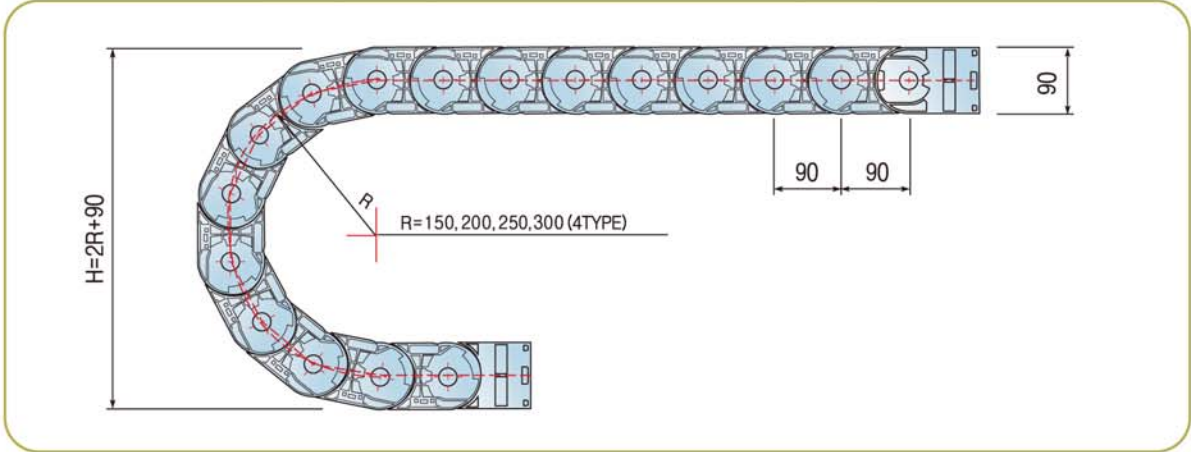

● **A-A Cross Section / D. Max**

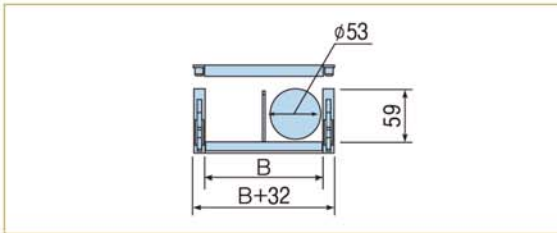

- Chain Length  $L = \frac{Ls}{2} + \pi R + 3P(2K)$
- 곡률반경에 따른 H값

R	150	200	250	300
H	390	490	590	690

● **B118**

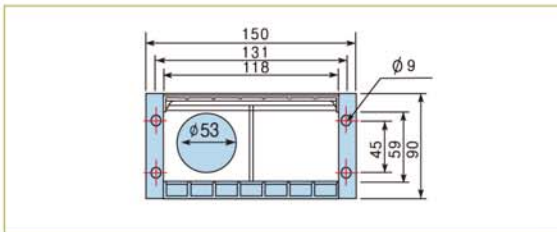

● **B168**

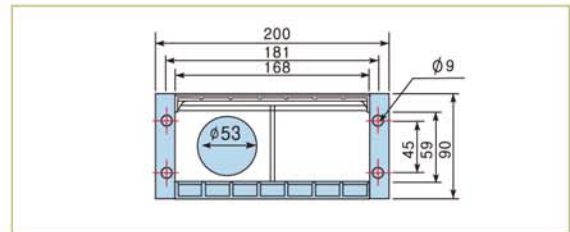

● **End Bracket**

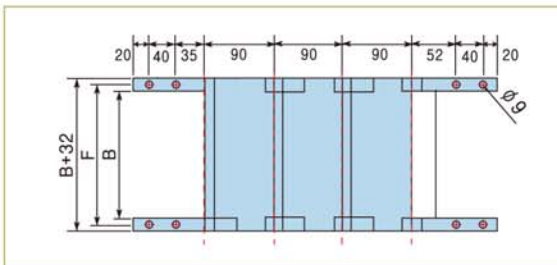

단위 mm

SERIES WITH RODS	F(B+13)
KJC 090-B118	131
KJC 090-B168	181

● **Order Example** [주문예]

KJC 090-B118 / Type → R200 / Radius → 40L/K / Length → 10Sets / Q'ty