

AVM Series Voice Coil Actuators



- Direct drive, zero cogging, zero backlash voice coil motors
- Low coil mass with very fast response and bandwidth
- No contact between coil and core movement (no wear and tear)
- Smooth motion at low speeds with limitless resolution
(depends on feedback device)

AVM Series Specifications

Model	Units	AVM 12-6.4	AVM 19-5	AVM 20-10	AVM24-5	AVM24-10
Stroke	mm	6.4	5	10	5	10
Force sensitivity (at mid stroke)	N/A	0.57	1.75	2.00	3.00	3.90
Back EMF constant	V/m/s	0.57	1.75	2.00	3.00	3.90
Continuous force (at 100 °C)*	N	0.91	1.75	1.56	2.10	2.65
Continuous force (at 155 °C)*	N	1.14	2.22	2.18	2.85	3.59
Peak force	N	3.5	7.9	7.6	11.4	14.8
Resistance	ohms	1.13	2.2	3.6	3.1	5.9
Inductance	mH	0.09	0.27	0.50	0.51	1.23
Voltage at peak force	V	7.0	10.0	13.6	11.7	22.3
Continuous current (coil at 100 °C)*	A	1.60	1.00	0.78	0.70	0.68
Continuous current (coil at 155 °C)*	A	2.00	1.27	1.09	0.95	0.92
Peak current	A	6.2	4.5	3.8	3.8	3.8
Actuator constant	N/SqRt(W)	0.54	1.17	1.06	1.71	1.61
Continuous power (at 100 °C)*	W	2.89	2.23	2.18	1.51	2.71
Electrical time constant	ms	0.1	0.1	0.1	0.2	0.2
Mechanical time constant	ms	17.4	6.0	9.7	3.4	7.1
Clearance of coil	mm	0.35	0.40	0.50	0.50	0.50
Power at peak force	W	43.4	45.2	51.8	44.6	84.6
Thermal dissipation constant	W/°C	0.039	0.030	0.029	0.020	0.036
Max coil temperature	°C	155.0	155.0	155.0	155.0	155.0
Coil assembly mass	g	5.0	8.3	10.8	9.8	18.3
Core assembly mass	g	7.9	24.3	32.1	30.7	45.0

* Continuous force measured without any additional mounting plate or heat sink on coil

Model	Units	AVM 30-15	AVM 40-20	AVM 60-25	AVM 90-30
Stroke	mm	15	20	25	30
Force sensitivity (at mid stroke)	N/A	7.35	12.90	17.00	22.50
Back EMF constant	V/m/s	7.35	12.90	17.00	22.50
Continuous force (at 100 °C)*	N	4.63	9.93	26.35	74.25
Continuous force (at 155 °C)*	N	5.88	13.16	34.00	96.75
Peak force	N	29.4	58.1	119.0	315.0
Resistance	ohms	10.2	12.1	5.4	2.7
Inductance	mH	2.63	5.12	3.73	3.20
Voltage at peak force	V	40.9	54.5	37.6	37.8
Continuous current (coil at 100 °C)*	A	0.63	0.77	1.55	3.3
Continuous current (coil at 155 °C)*	A	0.80	1.02	2.00	4.3
Peak current	A	4.0	4.5	7.0	14.0
Actuator constant	N/SqRt(W)	2.30	3.71	7.34	13.69
Continuous power (at 100 °C)*	W	4.06	7.17	12.90	29.40
Electrical time constant	ms	0.3	0.4	0.7	1.2
Mechanical time constant	ms	4.8	4.8	4.0	4.3
Clearance of coil	mm	0.60	0.60	0.70	0.65
Power at peak force	W	163.5	245.0	263.1	529.2
Thermal dissipation constant	W/°C	0.054	0.096	0.172	0.392
Max coil temperature	°C	155.0	155.0	155.0	155.0
Coil assembly mass	g	25.6	65.8	214.6	800.0
Core assembly mass	g	95.3	226.1	684.0	1750.0

* Continuous force measured without any additional mounting plate or heat sink on coil

AVM12-6.4

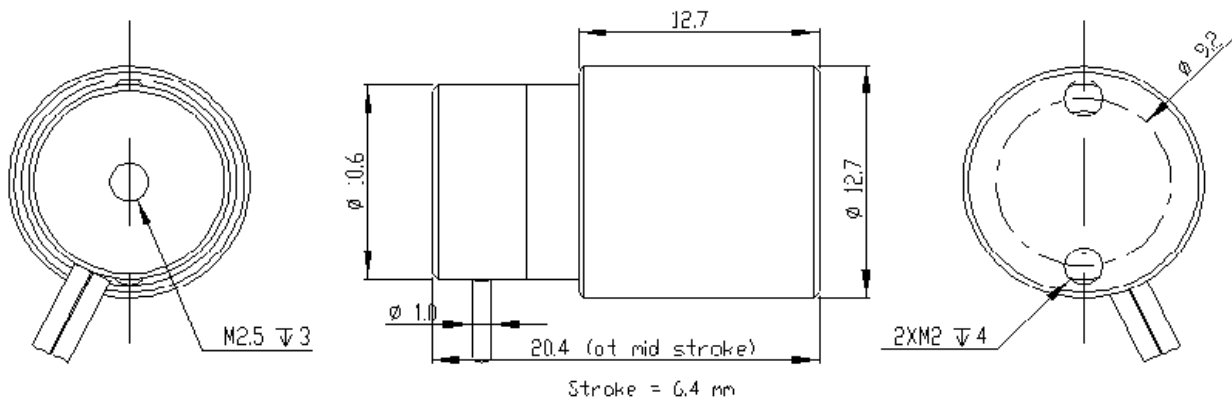

AVM19-5

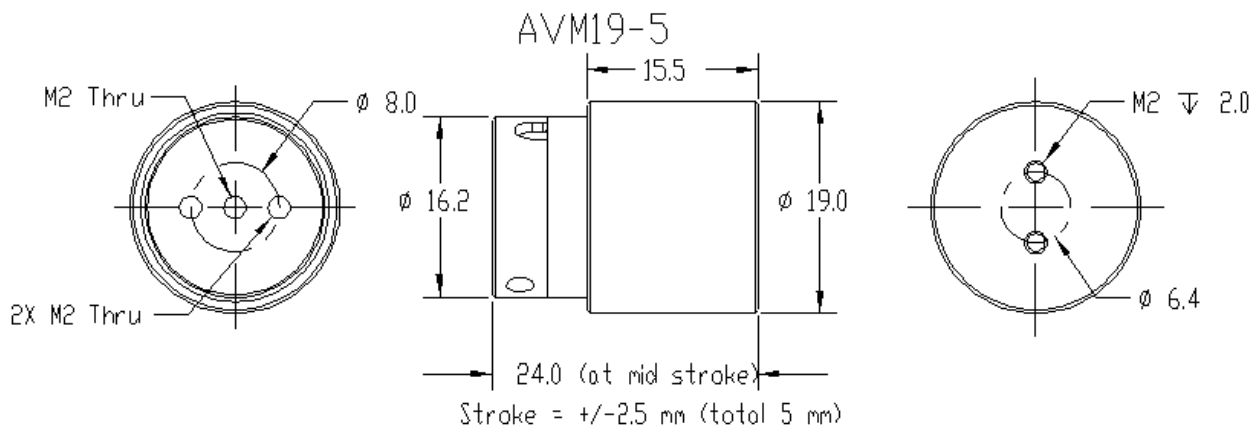

AVM20-10

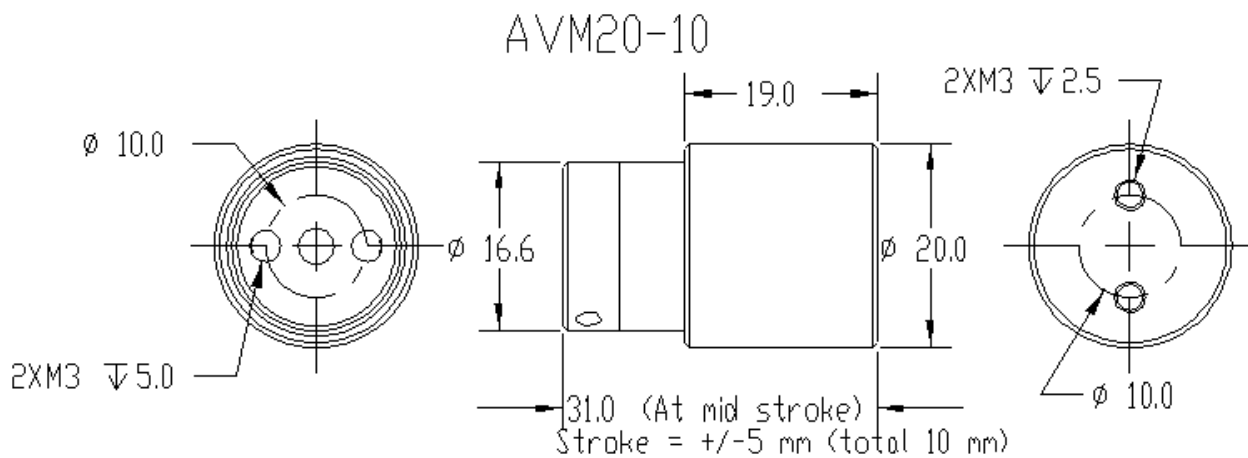

AVM24-5

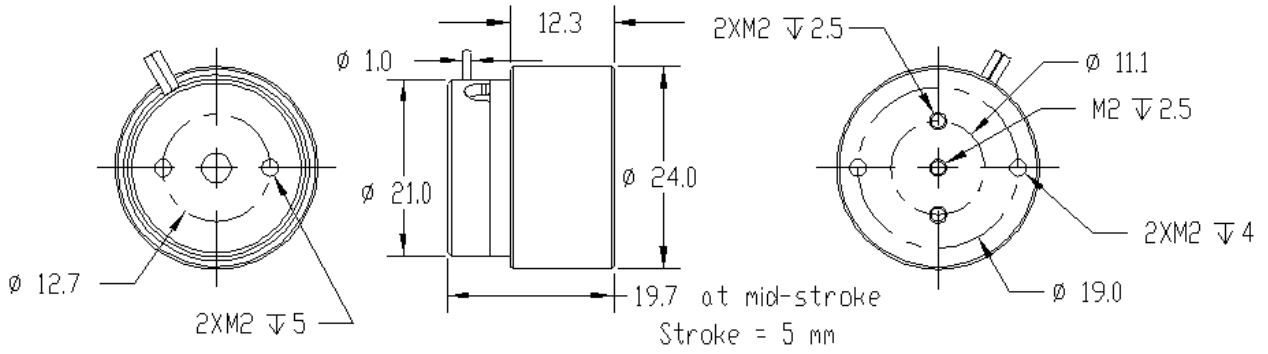

AVM24-10

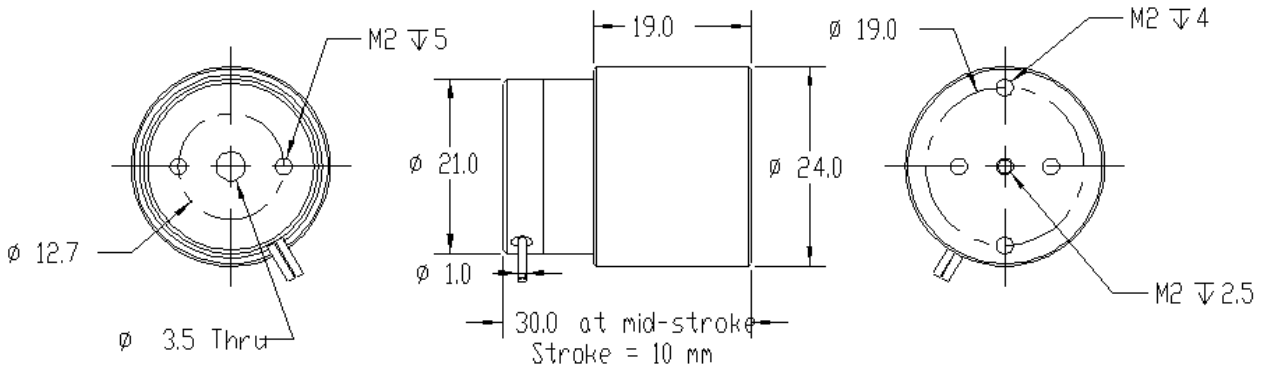

AVM30-15

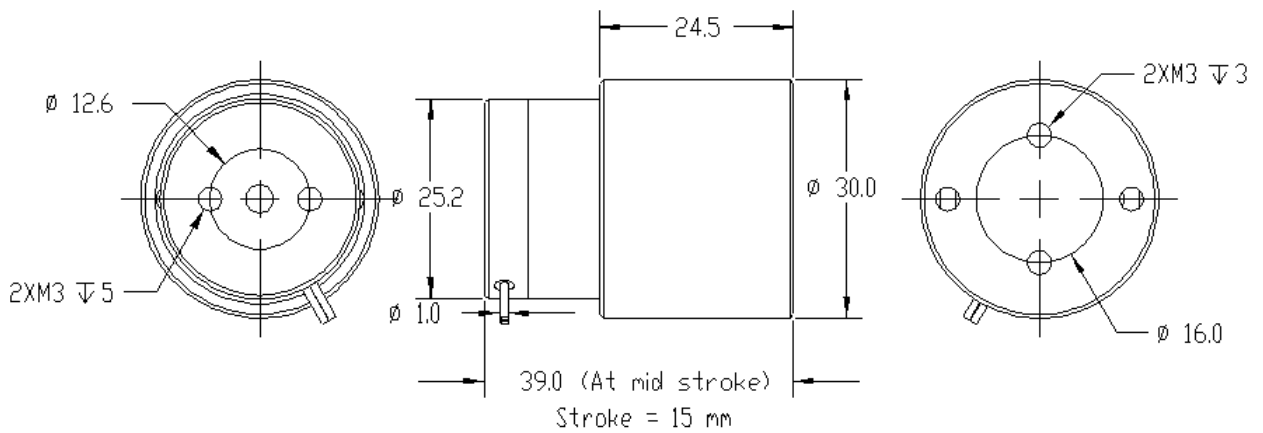

AVM40-20

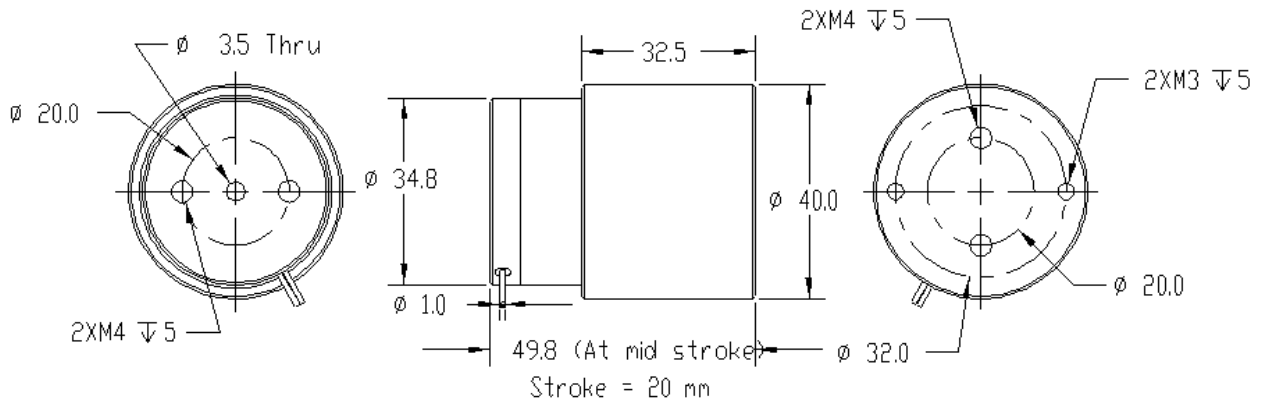

AVM60-25

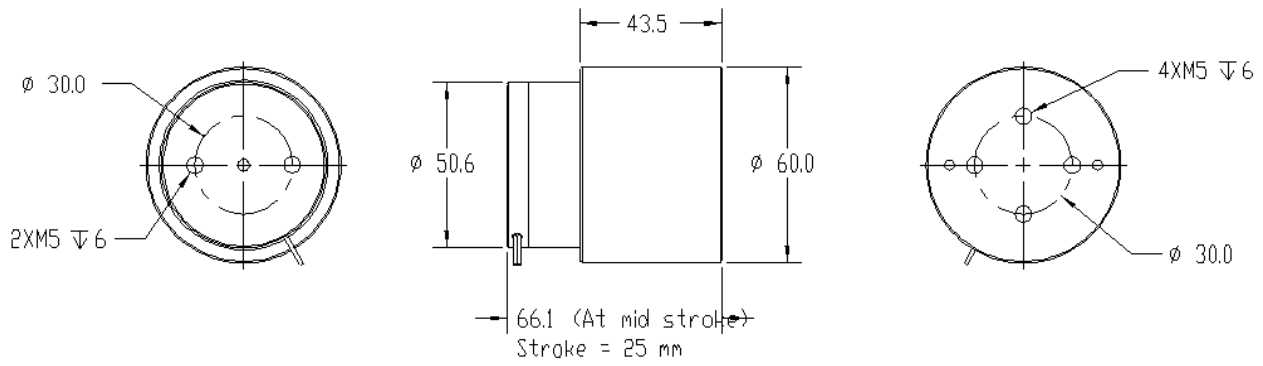

AVM90-30

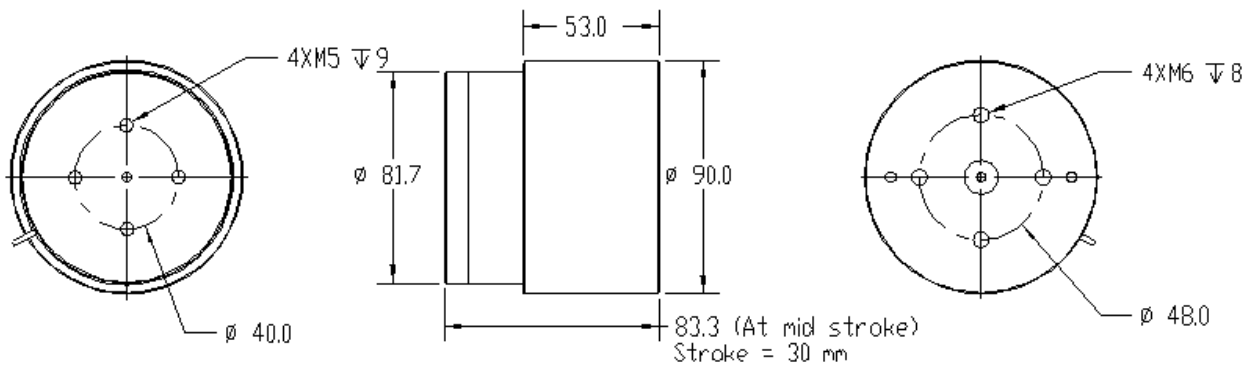

AVM-HF Series Specifications (Patented Design)

Model	Units	AVM 35-HF-7	AVM 40-HF-6.5	AVM 50-HF-10	AVM 60-HF-10
Stroke	mm	7	6.5	10	10
Force sensitivity (at mid stroke)	N/A	16.00	20.70	28.00	32.00
Back EMF constant	V/m/s	16.00	20.70	28.00	32.00
Continuous force (at 100 °C)*	N	14.40	16.56	33.60	51.20
Continuous force (at 155 °C)*	N	18.40	22.77	43.68	67.20
Peak force	N	72.0	93.2	140.0	224.0
Resistance	ohms	9.8	11.3	8.6	5.9
Inductance	mH	3.60	4.47	5.30	4.01
Voltage at peak force	V	44.1	50.9	43.2	41.4
Continuous current (coil at 100 °C)*	A	0.90	0.80	1.20	1.60
Continuous current (coil at 155 °C)*	A	1.15	1.10	1.56	2.10
Peak current	A	4.5	4.5	5.0	7.0
Actuator constant	N/SqRt(W)	5.11	6.16	9.53	13.16
Continuous power (at 100 °C)*	W	7.94	7.24	12.44	15.13
Electrical time constant	ms	0.4	0.4	0.6	0.7
Mechanical time constant	ms	2.0	1.8	1.6	1.4
Clearance of coil	mm	0.50	0.60	0.60	0.70
Power at peak force	W	198.5	229.0	216.0	289.6
Thermal dissipation constant	W/°C	0.106	0.097	0.166	0.202
Max coil temperature	°C	155.0	155.0	155.0	155.0
Coil assembly mass	g	52.9	67.7	145.3	239.3
Core assembly mass	g	149.8	221.4	562.2	1018.0

* Continuous force measured without any additional mounting plate or heat sink on coil

Model	Units	AVM 90-HF-10	AVM 100-HF-10	AVM 130-HF-10	AVM 250-HF-20
Stroke	mm	10	10	10	20
Force sensitivity (at mid stroke)	N/A	43.62	55.00	54.60	168.40
Back EMF constant	V/m/s	43.62	55.00	54.60	168.40
Continuous force (at 100 °C)*	N	152.67	192.50	360.36	1111.44
Continuous force (at 155 °C)*	N	196.29	247.50	469.56	1448.24
Peak force	N	610.7	770.0	764.4	4715.2
Resistance	ohms	2.9	3.4	1.5	3.7
Inductance	mH	3.59	4.12	1.70	5.00
Voltage at peak force	V	40.6	47.9	20.7	103.6
Continuous current (coil at 100 °C)*	A	3.5	3.5	6.6	6.6
Continuous current (coil at 155 °C)*	A	4.5	4.5	8.6	8.6
Peak current	A	14.0	14.0	14.0	28.0
Actuator constant	N/SqRt(W)	25.61	29.74	44.88	87.55
Continuous power (at 100 °C)*	W	35.53	41.90	64.47	161.17
Electrical time constant	ms	1.2	1.2	1.1	1.4
Mechanical time constant	ms	1.5	1.2	0.7	0.8
Clearance of coil	mm	0.65	0.65	0.55	0.90
Power at peak force	W	568.4	670.3	290.1	2900.8
Thermal dissipation constant	W/°C	0.474	0.559	0.860	2.149
Max coil temperature	°C	155.0	155.0	155.0	155.0
Coil assembly mass	g/Kg	954.0	1077.0	1.40	5.90
Core assembly mass	g/Kg	2400.0	3277.0	9.40	27.20

* Continuous force measured without any additional mounting plate or heat sink on coil

AVM35-HF-7

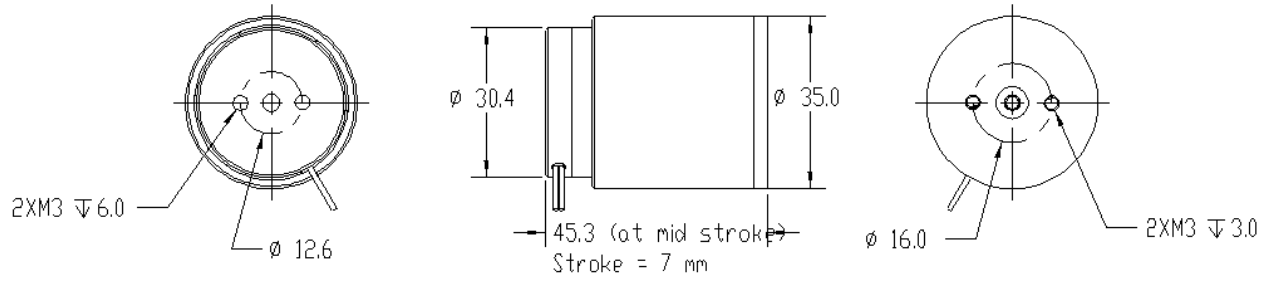

AVM40-HF-6.5

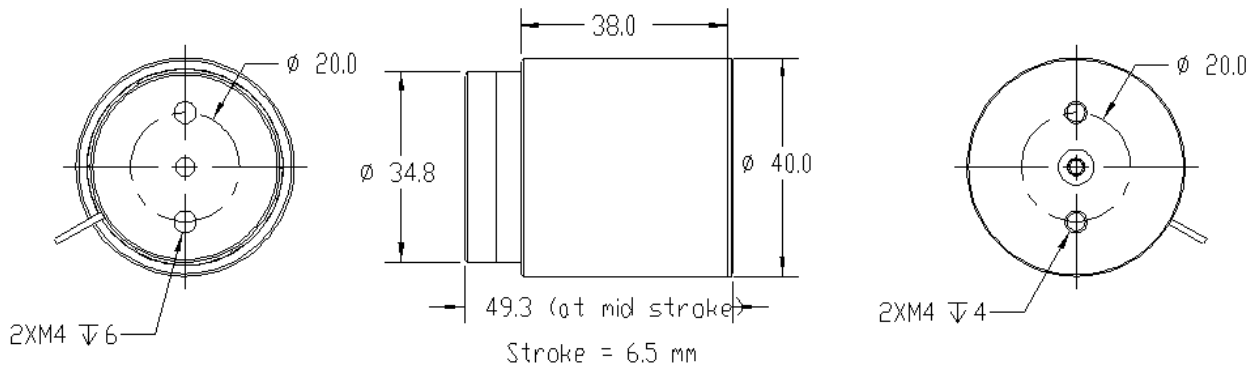

AVM50-HF-10

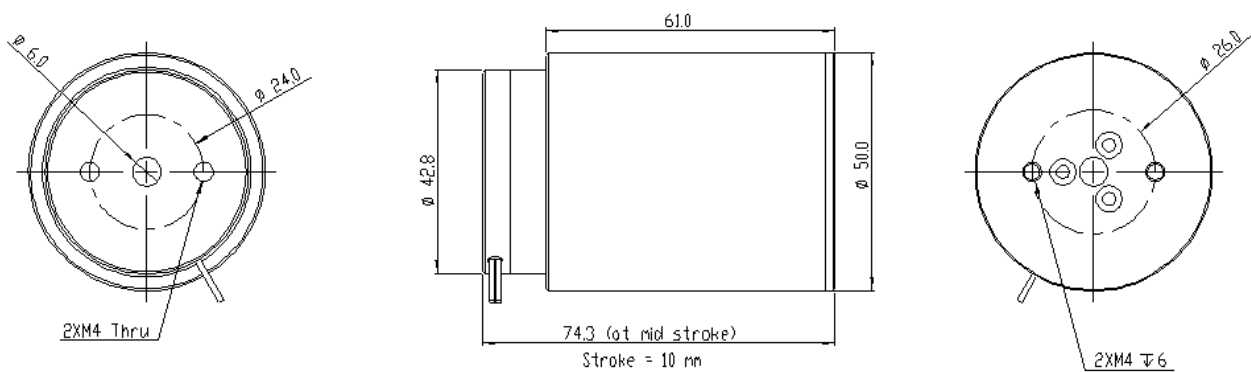

AVM60-HF-10

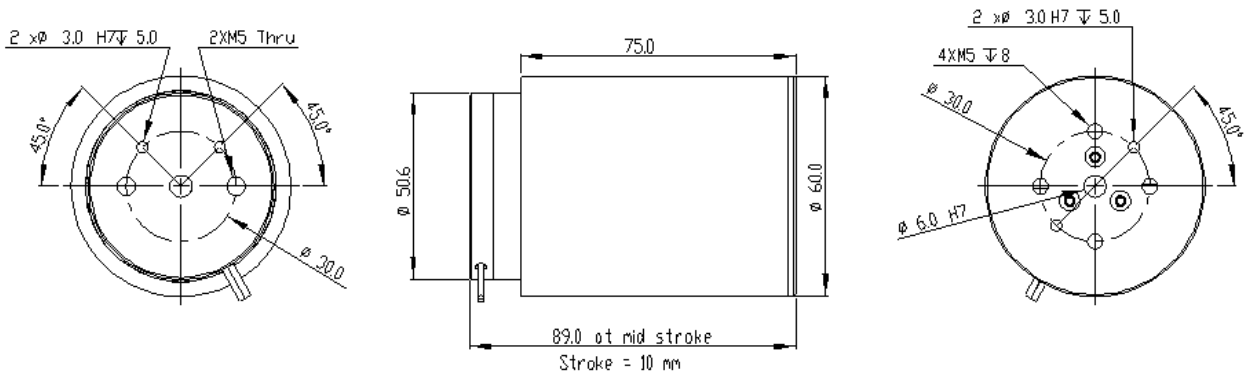

AVM90-HF-10

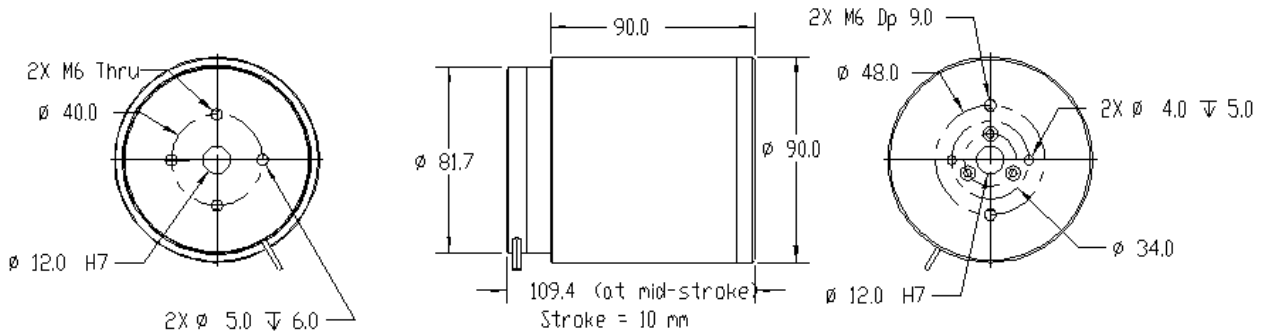

AVM100-HF-10

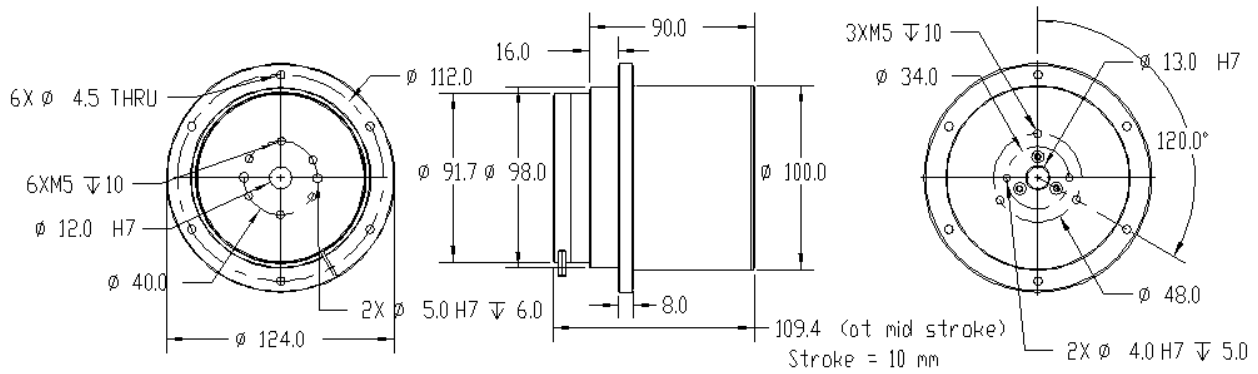

AVM130-HF-25

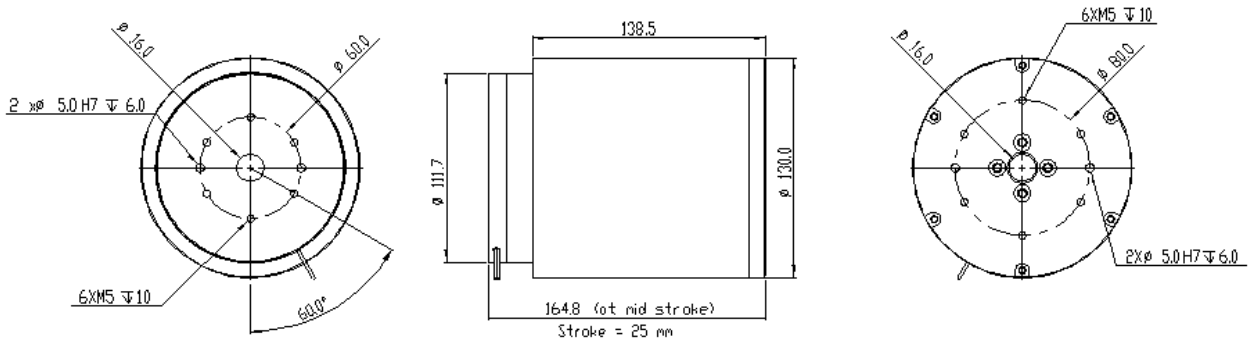

AVM250-HF-20

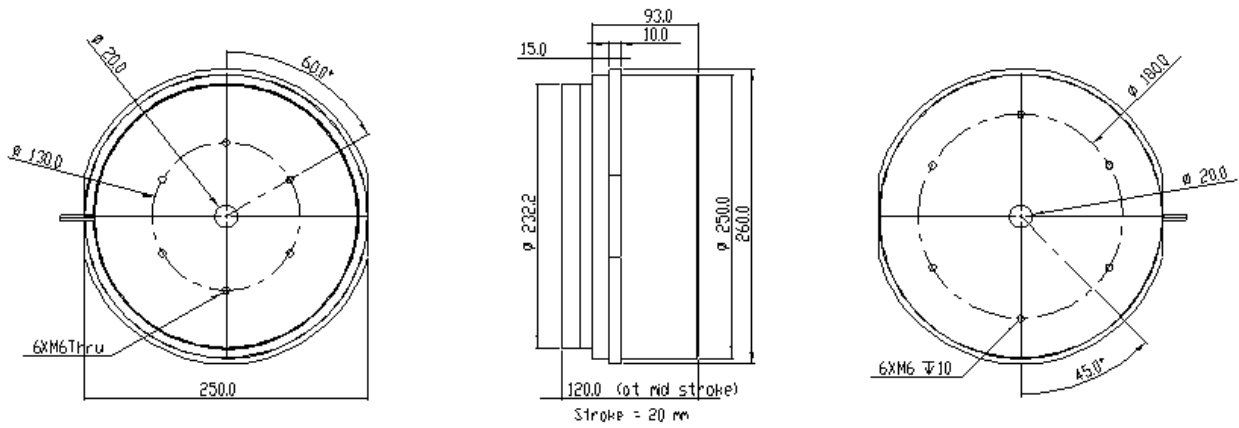

Part Numbering

Example: AVM30-15-0.5

Standard models:

Model and stroke	Cable length (m)
AVM 12-6.4	0.5
AVM 19-5	
AVM 20-10	
AVM 24-5	
AVM 24-10	
AVM 30-15	
AVM 40-20	
AVM 60-25	
AVM 90-30	

High force models:

Model and stroke	Cable length (m)
AVM 35-HF-7	0.5
AVM 40-HF-6.5	
AVM 50-HF-10	
AVM 60-HF-10	
AVM 90-HF-10	
AVM 100-HF-10	
AVM 130-HF-25	
AVM 250-HF-20	